

DATOS DE CURVA ESPIRAL PROYECTO

ORDEN	CD	CS	CA	LC	LA	LC	LA	LC	LA	LC	LA	LC	LA	LC	LA	LC	LA	LC	LA
1	142° 28' 41.25"	97° 28' 21.83"	21° 28' 08.30"	100.000	23.000	172.813	338.339	333.813	23.852	5.831	103.90	103.90	103.90	103.90	103.90	103.90	103.90	103.90	103.90

COORDINADAS PUNTO

COORD	NORTE	ESTE	ORTOMETRICA
P-1	967927.047	508163.825	722.241

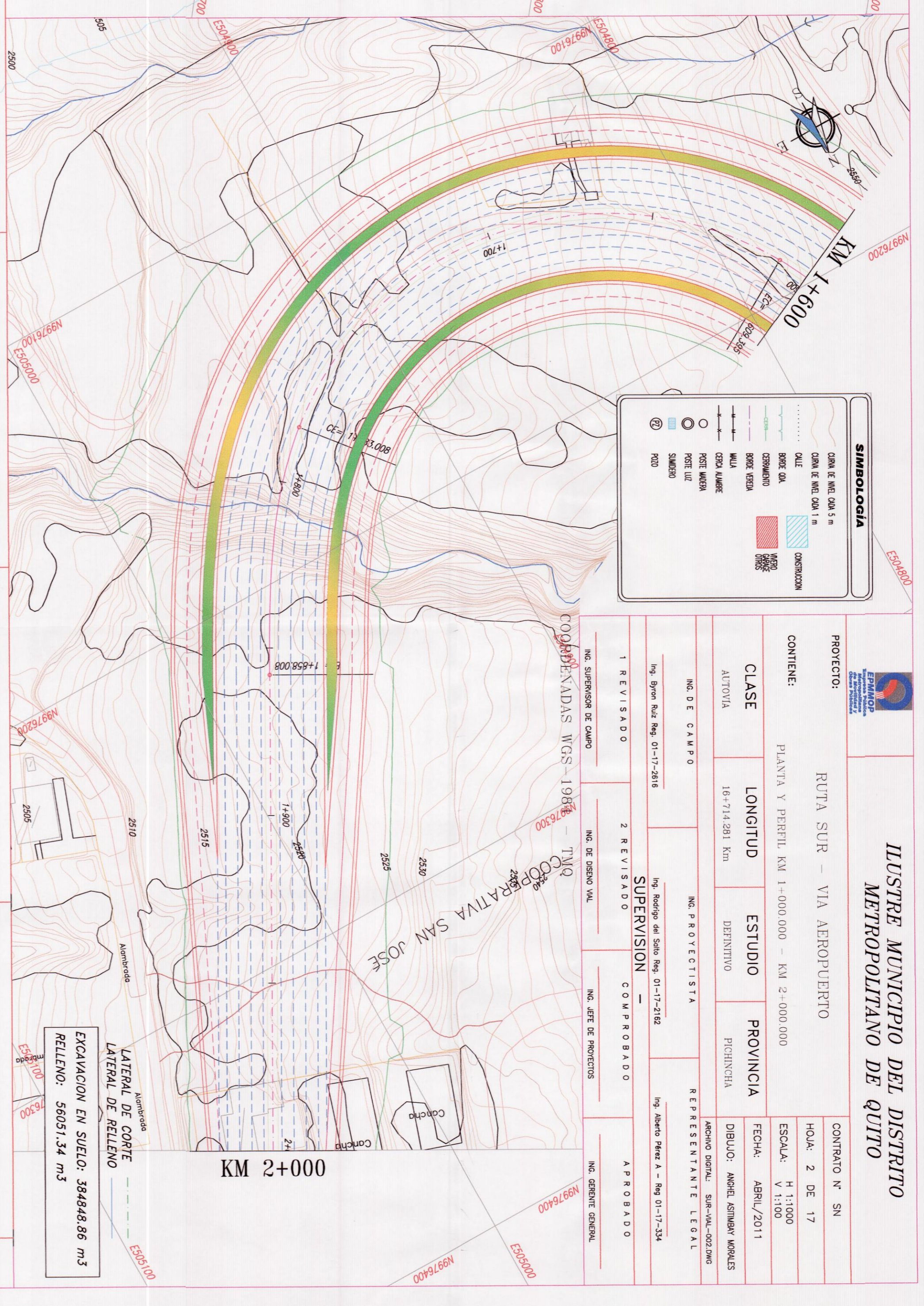
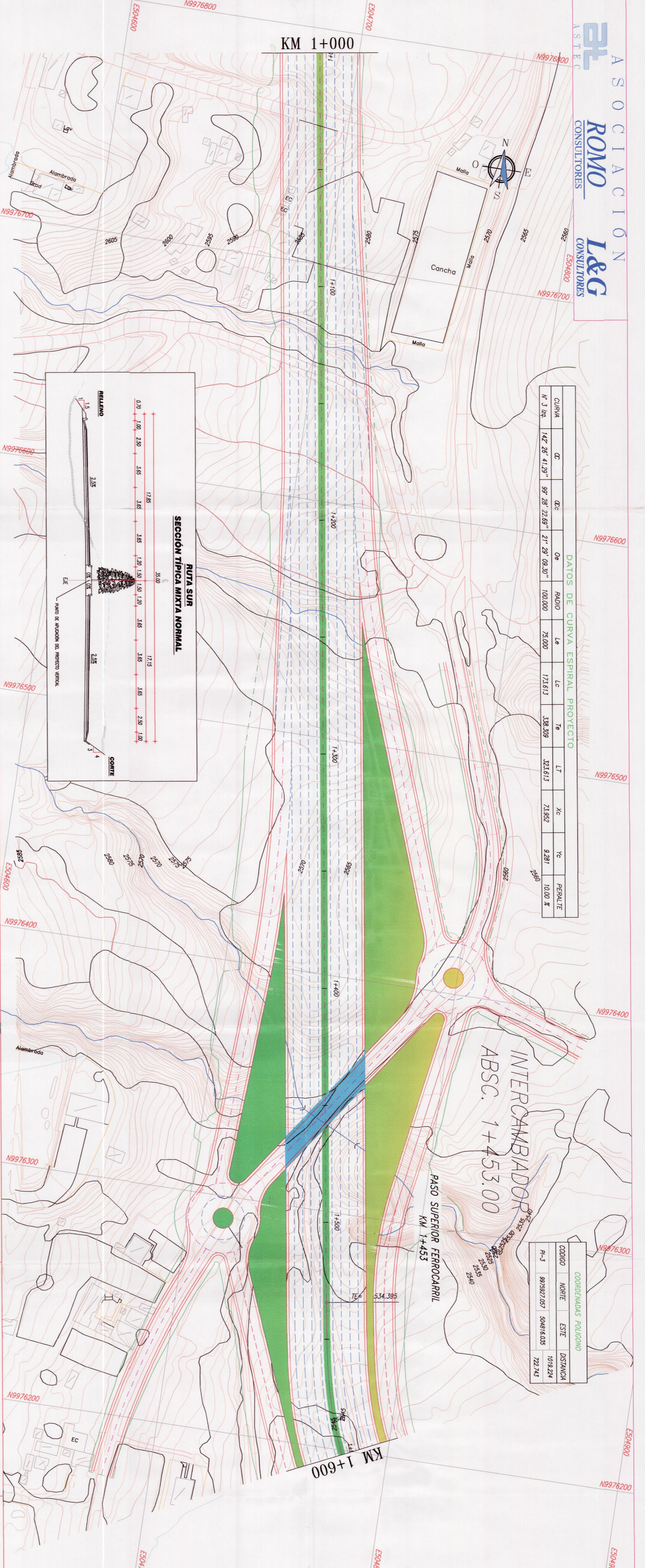

ELEVACION	RELLENO		COTE	PROYECTO	TERRENO	ABSISCA
	COMPLETO	REMANENTE				
2565	0.015	2565				
2570		2570				
2575		2575				
2580		2580				
2585		2585				
2590		2590				
2595		2595				
2597.0		2597.0				
2598.175		2598.175				
2598.430		2598.430				
2598.670		2598.670				
2598.910		2598.910				
2599.150		2599.150				
2599.390		2599.390				
2599.630		2599.630				
2599.870		2599.870				
2600.110		2600.110				
2600.350		2600.350				
2600.590		2600.590				
2600.830		2600.830				
2601.070		2601.070				
2601.310		2601.310				
2601.550		2601.550				
2601.790		2601.790				
2602.030		2602.030				
2602.270		2602.270				
2602.510		2602.510				
2602.750		2602.750				
2602.990		2602.990				
2603.230		2603.230				
2603.470		2603.470				
2603.710		2603.710				
2603.950		2603.950				
2604.190		2604.190				
2604.430		2604.430				
2604.670		2604.670				
2604.910		2604.910				
2605.150		2605.150				
2605.390		2605.390				
2605.630		2605.630				
2605.870		2605.870				
2606.110		2606.110				
2606.350		2606.350				
2606.590		2606.590				
2606.830		2606.830				
2607.070		2607.070				
2607.310		2607.310				
2607.550		2607.550				
2607.790		2607.790				
2608.030		2608.030				
2608.270		2608.270				
2608.510		2608.510				
2608.750		2608.750				
2608.990		2608.990				
2609.230		2609.230				
2609.470		2609.470				
2609.710		2609.710				
2609.950		2609.950				
2610.190		2610.190				
2610.430		2610.430				
2610.670		2610.670				
2610.910		2610.910				
2611.150		2611.150				
2611.390		2611.390				
2611.630		2611.630				
2611.870		2611.870				
2612.110		2612.110				
2612.350		2612.350				
2612.590		2612.590				
2612.830		2612.830				
2613.070		2613.070				
2613.310		2613.310				
2613.550		2613.550				
2613.790		2613.790				
2614.030		2614.030				
2614.270		2614.270				
2614.510		2614.510				
2614.750		2614.750				
2614.990		2614.990				
2615.230		2615.230				
2615.470		2615.470				
2615.710		2615.710				
2615.950		2615.950				
2616.190		2616.190				
2616.430		2616.430				
2616.670		2616.670				
2616.910		2616.910				
2617.150		2617.150				
2617.390		2617.390				
2617.630		2617.630				
2617.870		2617.870				
2618.110		2618.110				
2618.350		2618.350				
2618.590		2618.590				
2618.830		2618.830				
2619.070		2619.070				
2619.310		2619.310				
2619.550		2619.550				
2619.790		2619.790				
2620.030		2620.030				
2620.270		2620.270				
2620.510		2620.510				
2620.750		2620.750				
2620.990		2620.990				
2621.230		2621.230				
2621.470		2621.470				
2621.710		2621.710				
2621.950		2621.950				
2622.190		2622.190				
2622.430		2622.430				
2622.670		2622.670				
2622.910		2622.910				
2623.150		2623.150				
2623.390		2623.390				
2623.630		2623.630				
2623.870		2623.870				
2624.110		2624.110				
2624.350		2624.350				
2624.590		2624.590				
2624.830		2624.830				
2625.070		2625.070				
2625.310		2625.310				
2625.550		2625.550				
2625.790		2625.790				
2626.030		2626.030				
2626.270		2626.270				
2626.510		2626.510				
2626.750		2626.750				
2626.990		2626.990				
2627.230		2627.230				
2627.470		2627.470				
2627.710		2627.710				
2627.950		2627.950				
2628.190		2628.190				
2628.430		2628.430				
2628.670		2628.670				
2628.910		2628.910				
2629.150		2629.150				
2629.390		2629.390				
2629.630		2629.630				
2629.870		2629.870				
2630.110		2630.110				
2630.350		2630.350				
2630.590		2630.590				
2630.830		2630.830				
2631.070		2631.070				
2631.310		2631.310				
2631.550		2631.550				
2631.790		2631.790				
2632.030		2632.030				
2632.270		2632.270				
2632.510		2632.510				
2632.750		2632.750				
2632.990		2632.990				
2633.230		2633.230				
2633.470		2633.470				
2633.710		2633.710				
2633.950		2633.950				
2634.190		2634.190				
2634.430		2634.430				
2634.670		2634.670				
2634.910		2634.910				
2635.150		2635.150				
2635.390		2635.390				
2635.630		2635.630				
2635.870		2635.870				
2636.110		2636.110				
2636.350		2636.350				
2636.590		2636.590				
2636.830		2636.830				
2637.070		2637.070				
2637.310		2637.310				
2637.550		2637.550				
2637.790		2637.790				
2638.030		2638.030				
2638.270		2638.270				
2638.510		2638.510				
2638.750		2638.750				
2638.990		2638.990				
2639.230		2639.230				
2639.470		2639.470				
2639.710		2639.710				
2639.950		2639.950				
2640.190		2640.190				
2640.430		2640.430				
2640.670		2640.670				
2640.910		2640.910				
2641.150		2641.150				
2641.390		2641.390				
2641.630						