

1 4.1 NIVEL +7.50 - SECTOR A
ESC: 1:100

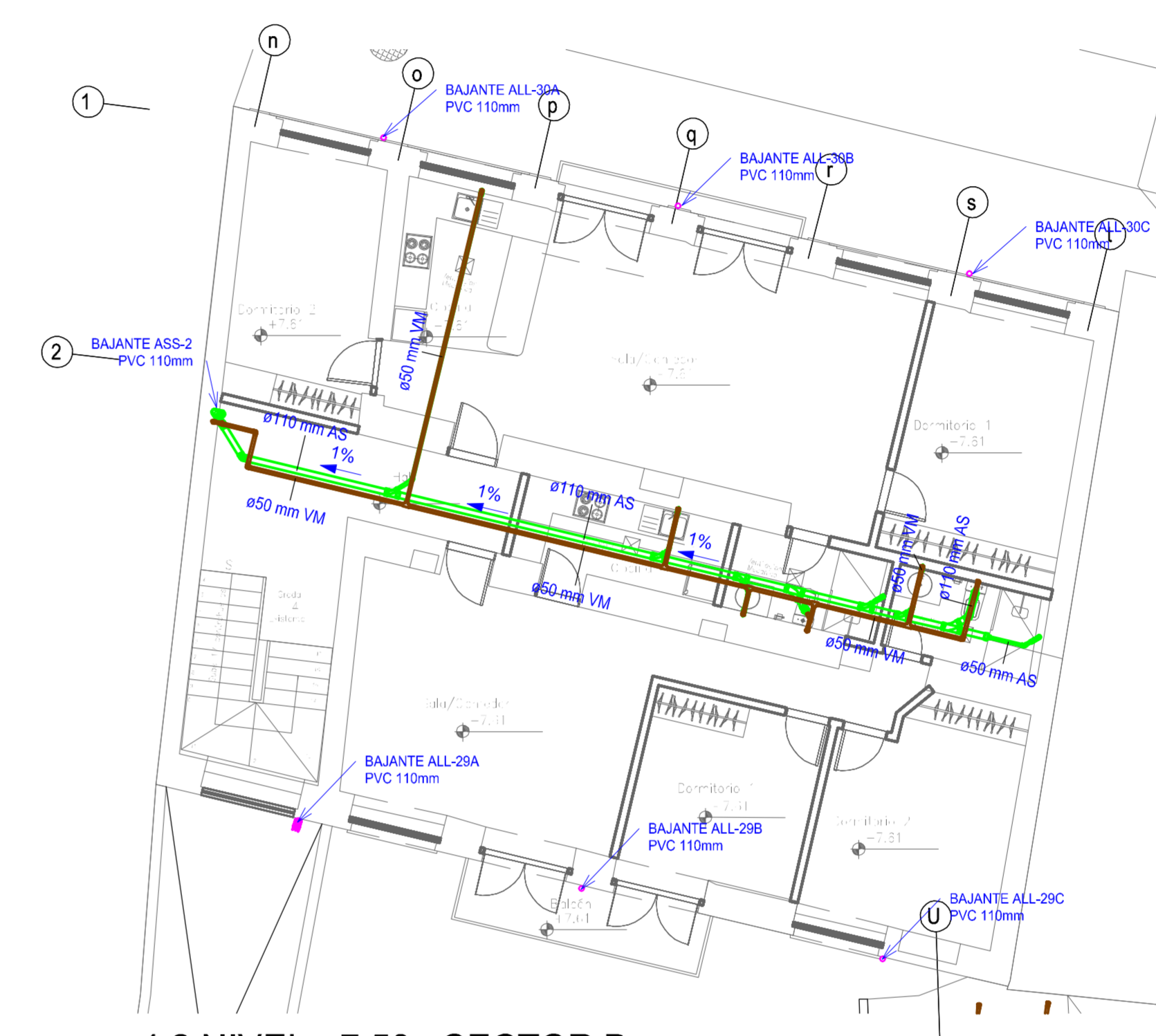

2 4.2 NIVEL +7.50 - SECTOR B
ESC: 1:100

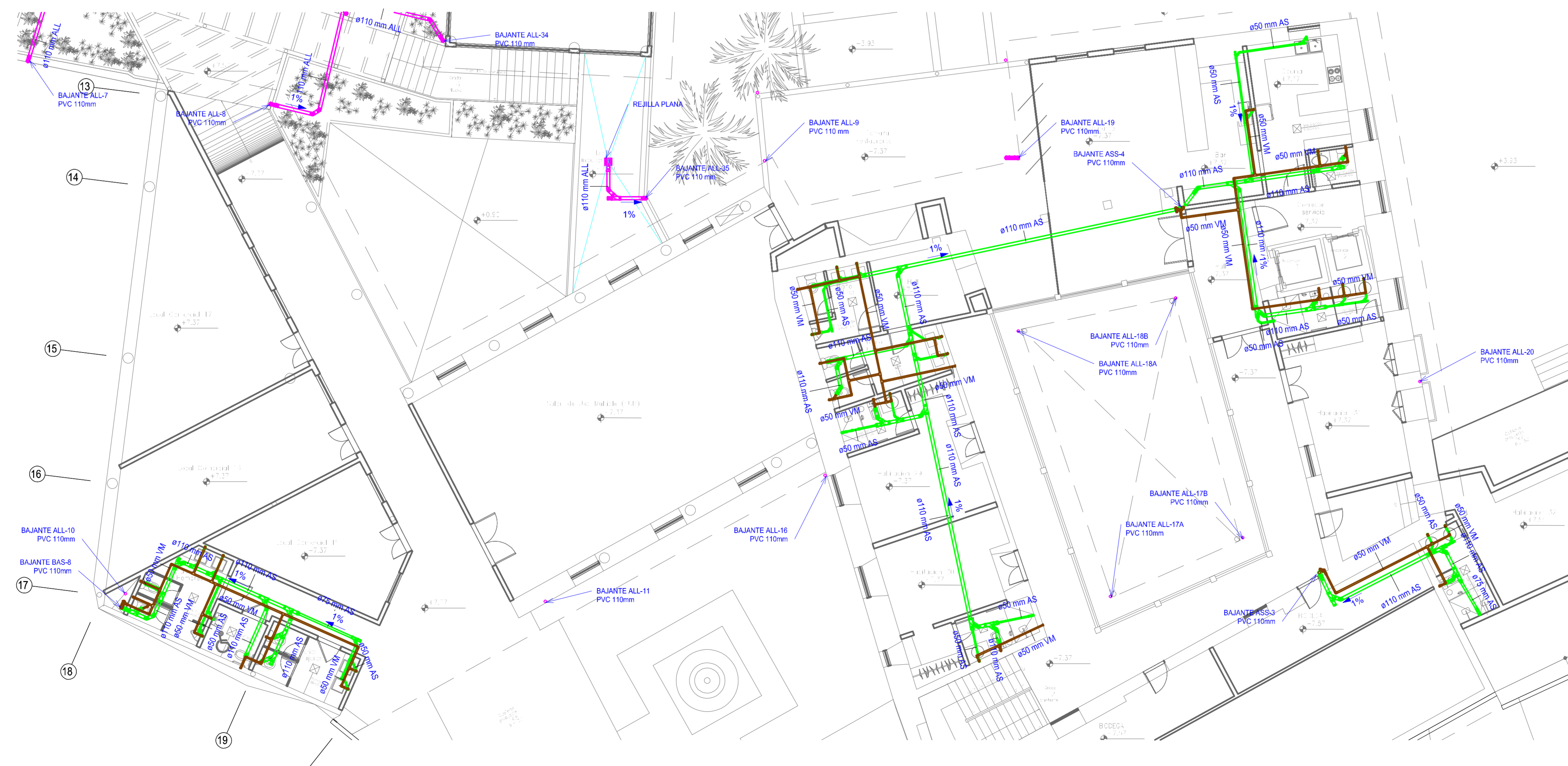

3 4.3 NIVEL +7.50 - SECTOR C
ESC: 1:100

| SIMBOLOGIA | |
|------------|---|
| | TUBERIA AGUAS SERVIDAS DOMESTICAS - PVC DESAGUE |
| | TUBERIA AGUAS DE AGUAS LUVIAS - PVC DESAGUE |
| | TUBERIA VENTILACION SANITARIA - PVC VENTILACION |
| | CORDO 90° |
| | CORDO 45° |
| | TEE SANITARIA |
| | YEE SANITARIA |
| | ADAPTADOR DE EMPLEZA |
| | SF80 |
| | REJILLA |
| | REDUCCION |
| | YEE SANITARIA + CORDO 45 |
| | A.S. BAJANTE DE AGUAS SERVIDAS |
| | A.L.L. BAJANTE DE AGUA LUVIA |
| | SENTIDO DE FLUJO |
| | CAJA DE REVISION SANITARIA |
| | POZO SANITARIO |

NOTAS

| | | | | | |
|---|----------|-------|--|--------------|----------|
| PROYECTO LA LOMA | | | | | |
| Av. Pedro Vicente Maldonado y Joaquín Paredes-La Loma-Centro Histórico | | | | | |
| SISTEMA AGUAS SERVIDAS Y LUVIAS | | | | | |
| NIVEL +7.50 SECTOR A - B & C | | | | | |
| <table border="1"> <tr> <td>MAI 2022</td> <td>1:100</td> </tr> </table> | MAI 2022 | 1:100 | <table border="1"> <tr> <td style="text-align: center;">IS-16</td> </tr> <tr> <td style="text-align: right;">10 DE 22</td> </tr> </table> | IS-16 | 10 DE 22 |
| MAI 2022 | 1:100 | | | | |
| IS-16 | | | | | |
| 10 DE 22 | | | | | |