

SUBSUELO
Esc. 1:100

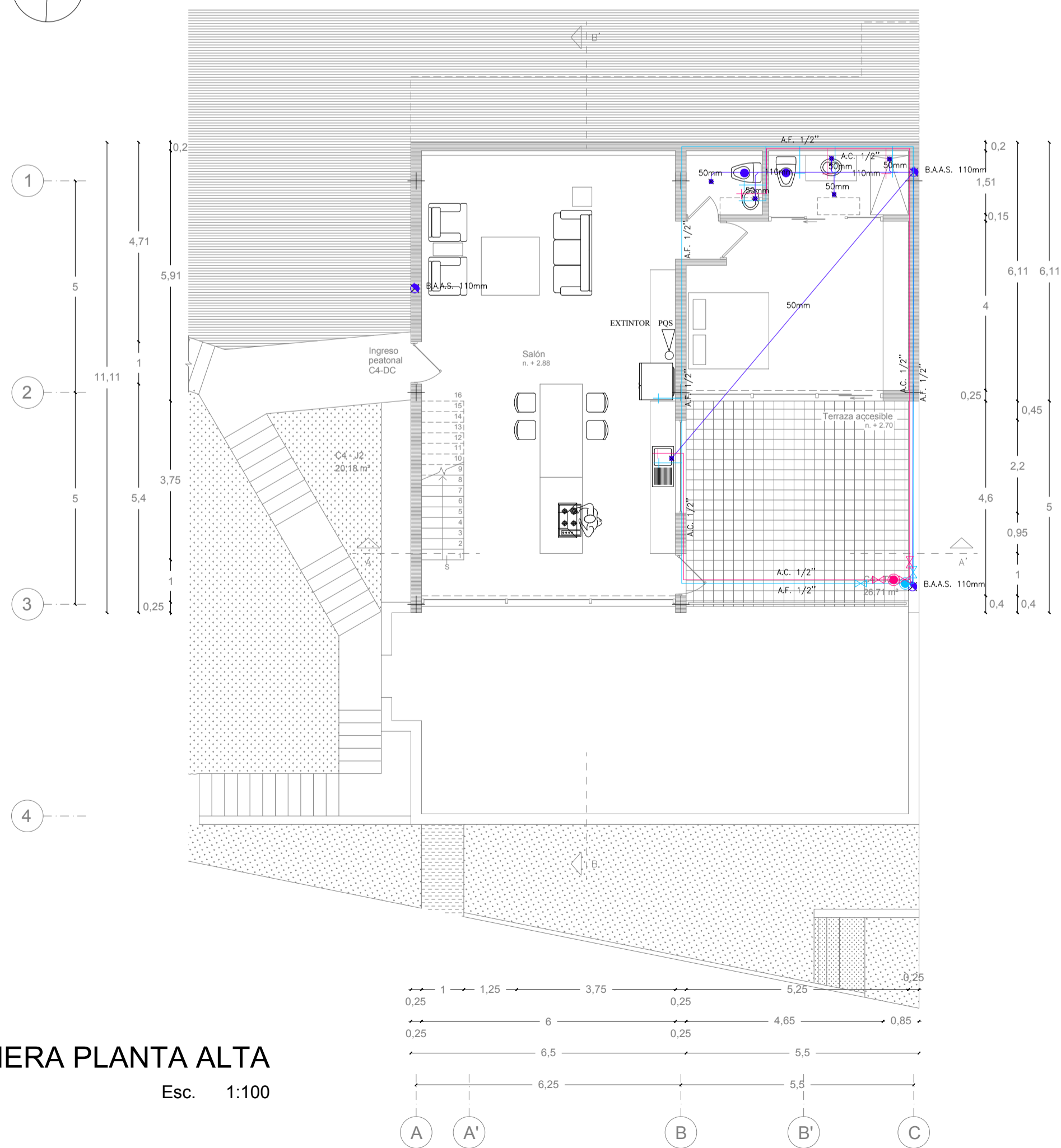

PRIMERA PLANTA ALTA
Esc. 1:100

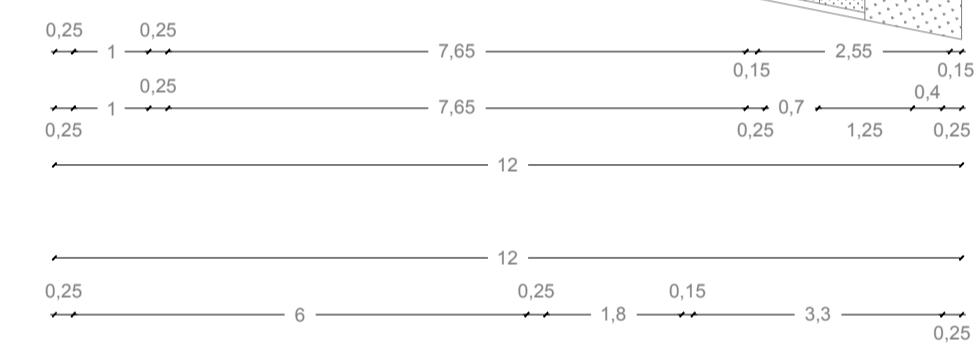
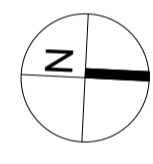
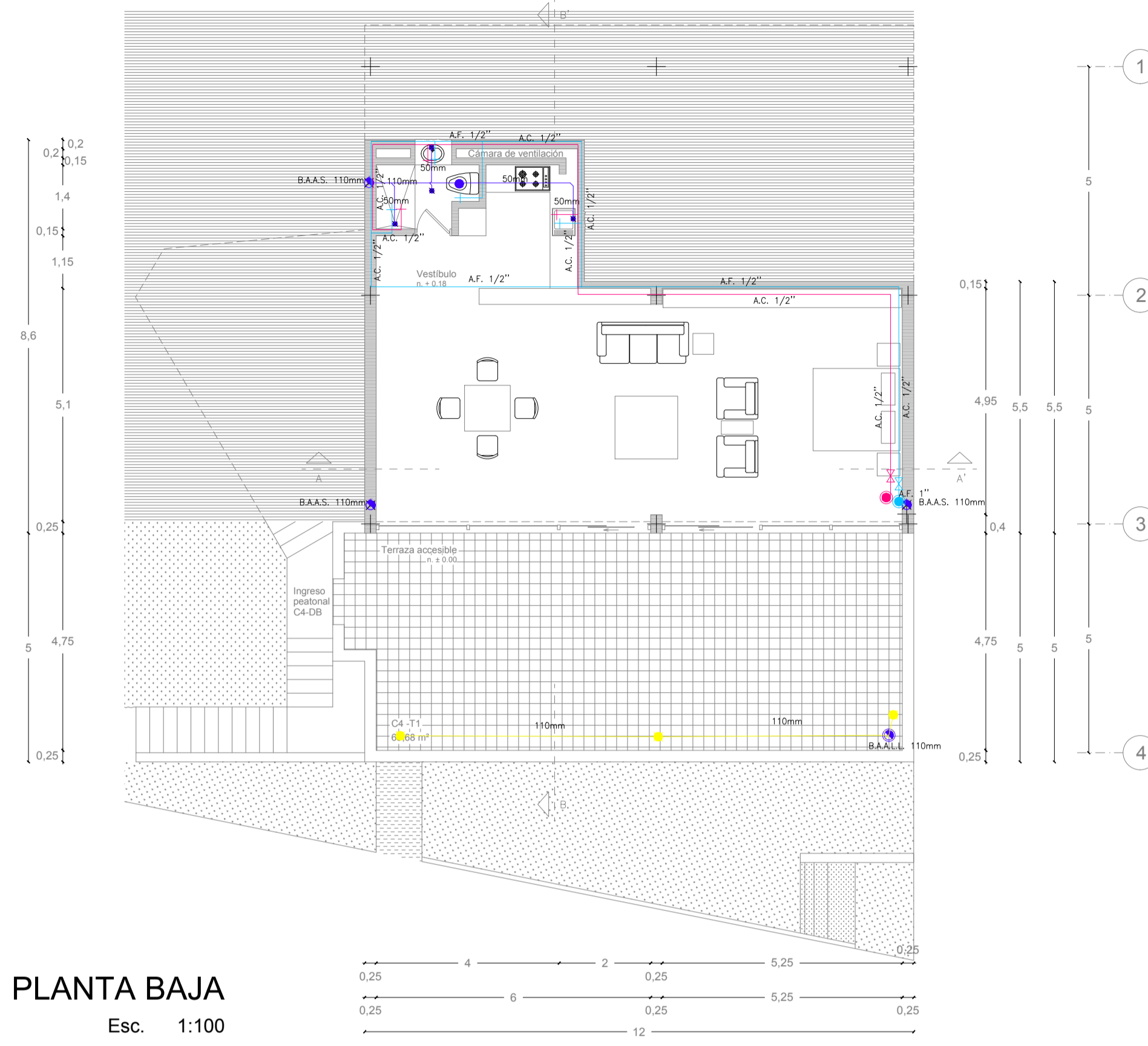
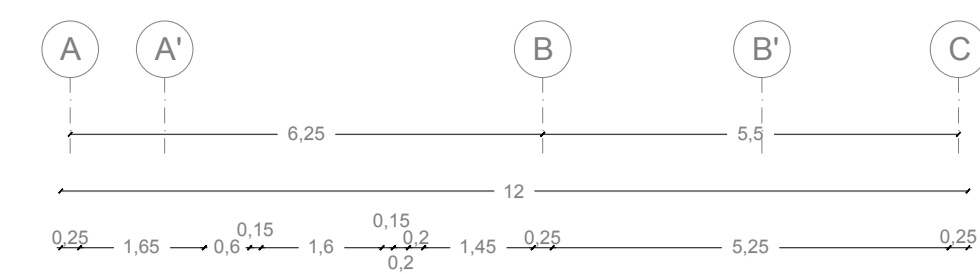
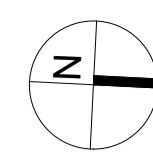

PLANTA BAJA
Esc. 1:100

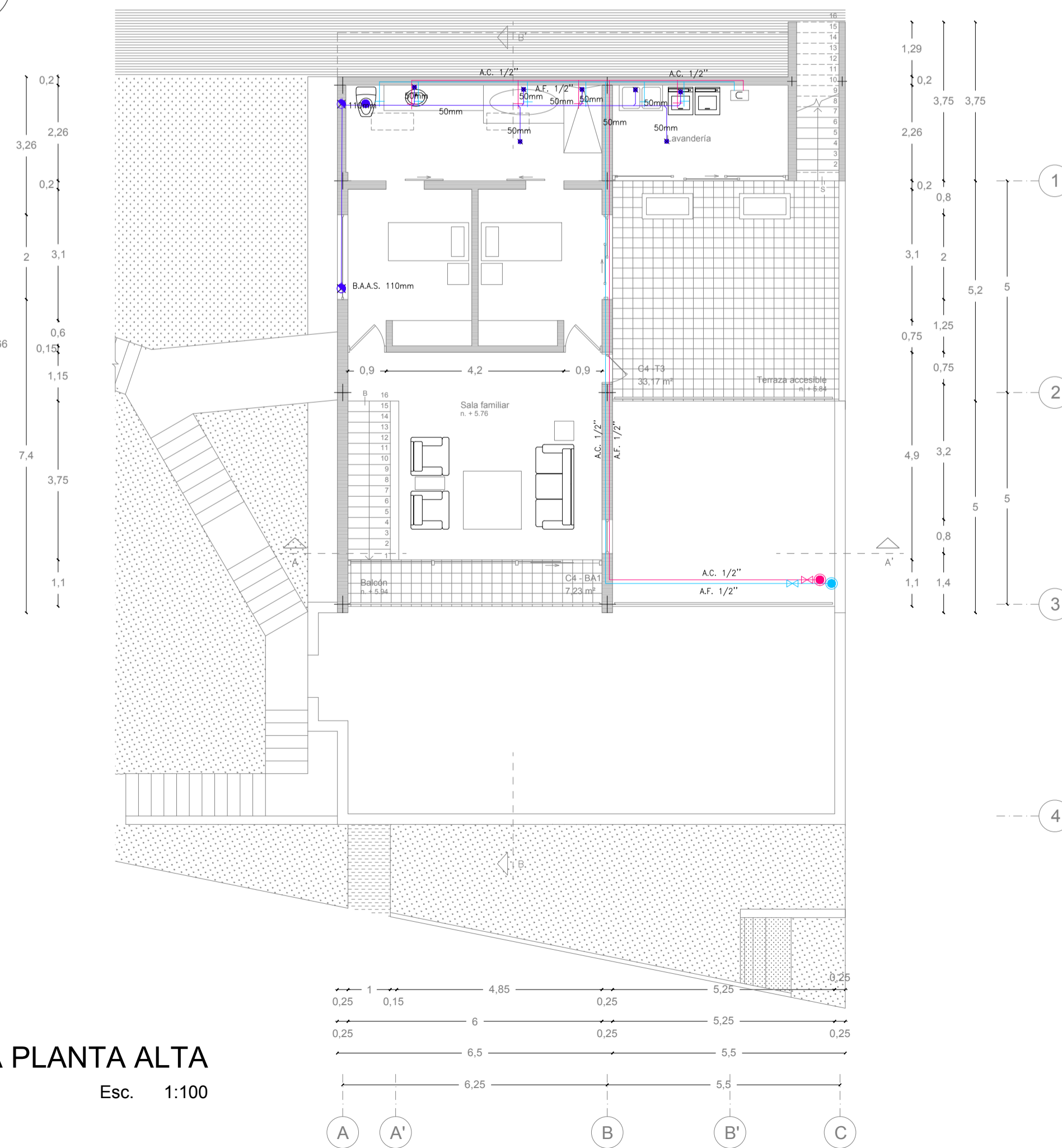
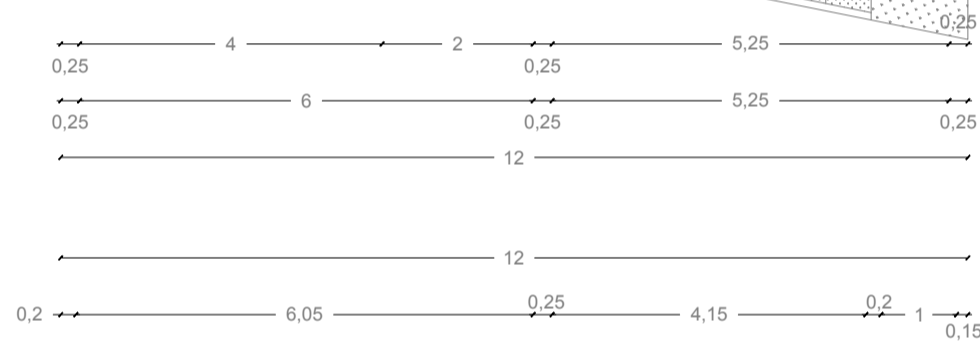
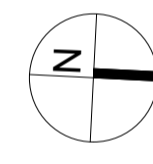

SEGUNDA PLANTA ALTA
Esc. 1:100

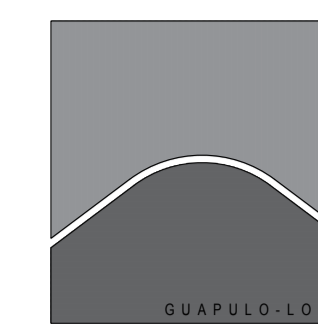

GUAPULO - LOMA
MODIFICATORIOS Y AMPLIATORIOS

PROPIETARIOS Y APODERADOS

Sr. Handel Guayasamín Crespo C.I. 170300341 - 6
Sr. Igor Guayasamín Crespo C.I. 170385295 - 2

UBICACION

Camino de Orellana S/N - Guápulo / Itchimbia
Administración Zonal Centro (Manuela Sáenz)
Número de predio 530987 Clave catastral 10407 04 015 000 000 000
IRM N° 737360 de 2021 - 01 - 29
Zonificación A8 (A603 - 35) / H2 (D203H - 70)

PROYECTO ARQUITECTÓNICO

Handel Guayasamín C., Arq.
CAE P887 / AM 1462 SENESCYT 1005-08-851467
Santiago Cueva B., Arq.
CAE P5788 / AM 7302 SENESCYT 1027-04-545091

COLABORACIÓN : Rolando González Vargas, Arq.

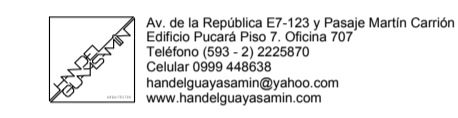

CONSULTOR PROYECTO HIDROSANITARIO

Ing. Fabián Miño Rojas
PM DMQ 4627 CICP 01-17-3624 SENESCYT 1001-10-983458

CONTIENE **CASA 4 (C4)**
PLANTA SUBSUELO
PLANTA BAJA
PRIMERA PLANTA ALTA
SEGUNDA PLANTA ALTA

ESCALA INDICADA

FECHA FEBRERO 2021

CODIGO

AR

LAMINA

DE

06 08

SELLOS MUNICIPALES