

**PLANTA DE CUBIERTA**  
ESCALA 1:50

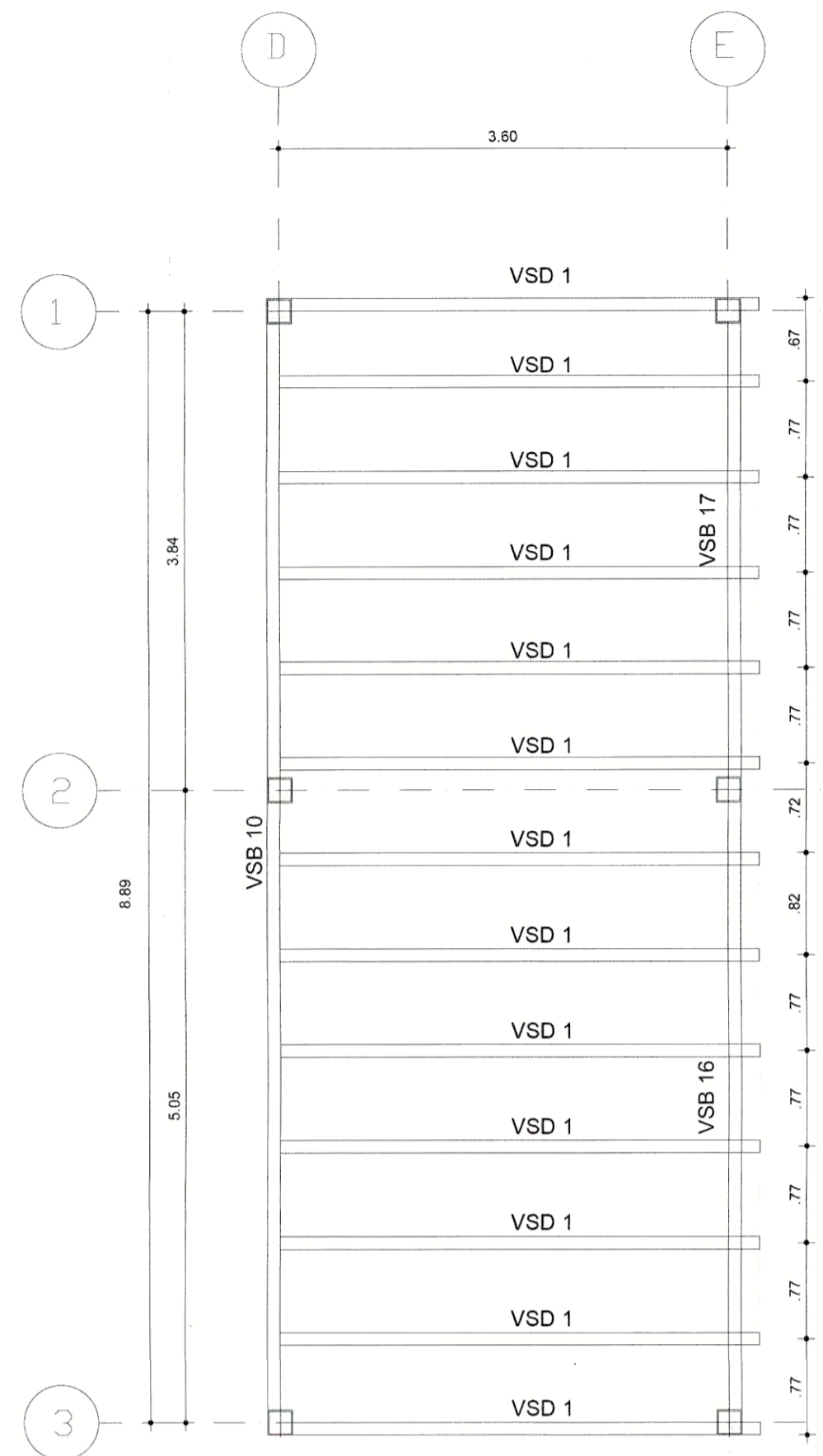

**CUBIERTA TIPO PERGOLA Nv +6.49**  
ESCALA 1:50

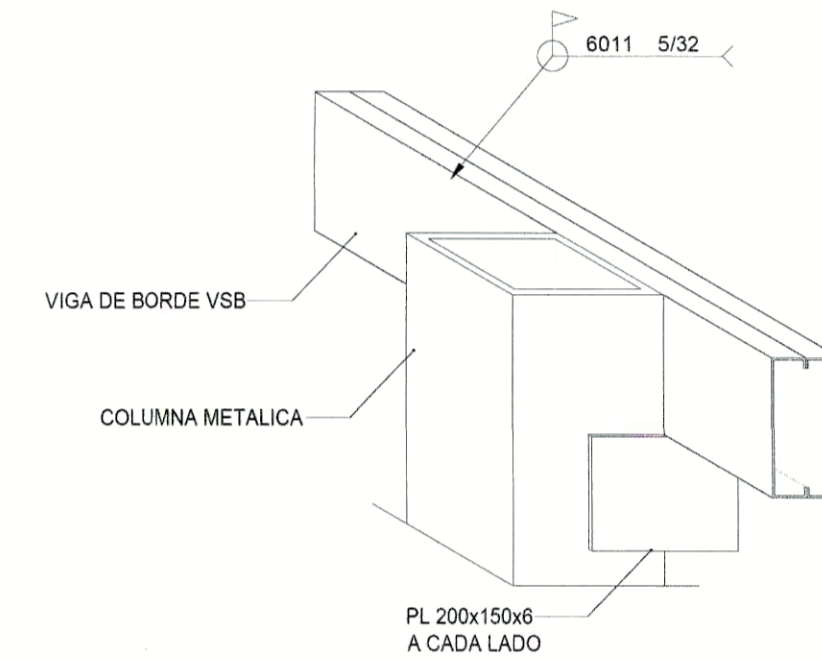
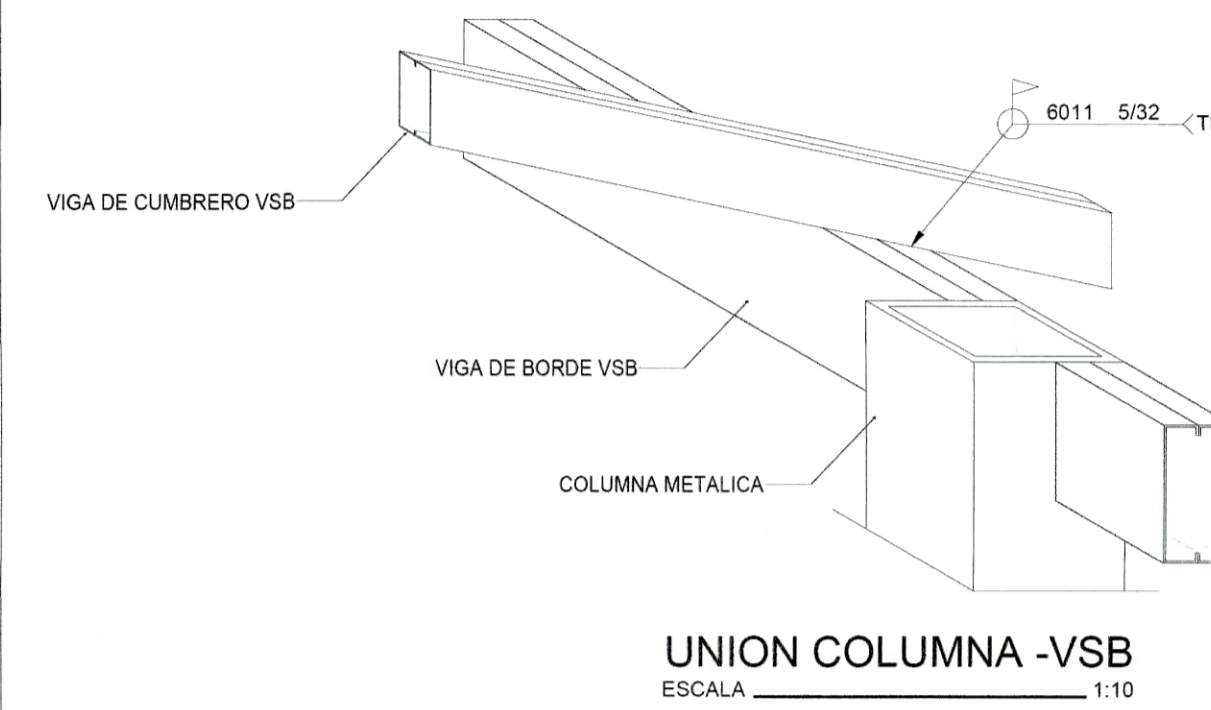
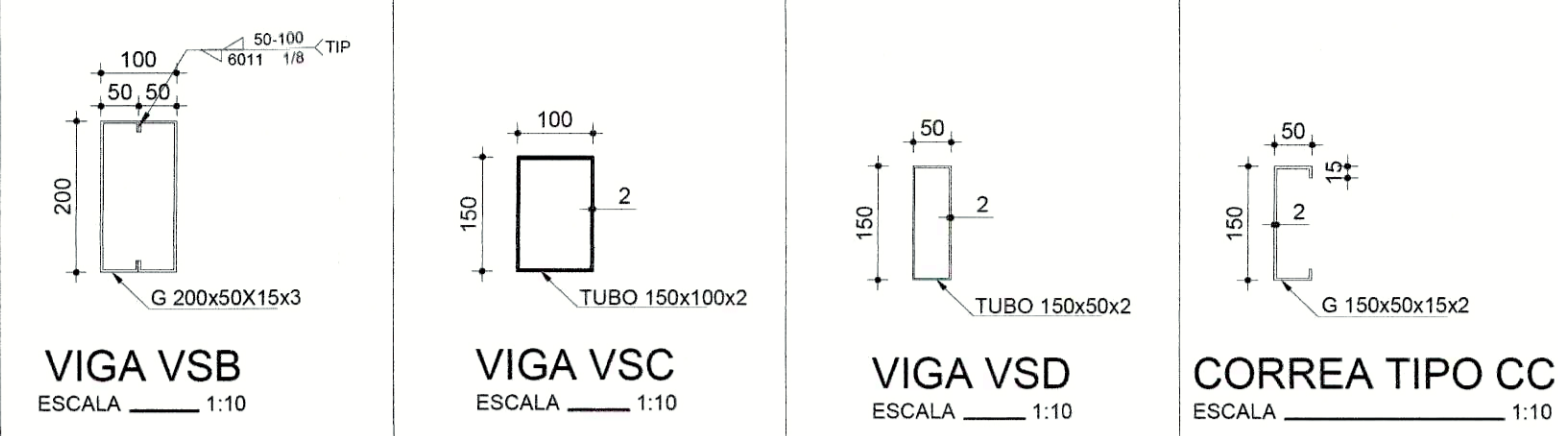

**CONEXION TIPO A  
UNION COLUMNA -VSB**  
ESCALA 1:10

**PLANILLA DE HIERROS**

Mc	Diam	No	Tipo	DIMENSIONES			LONGITUD		OBSERVACIONES
				a	b	c	L.PAR	L.TOT	

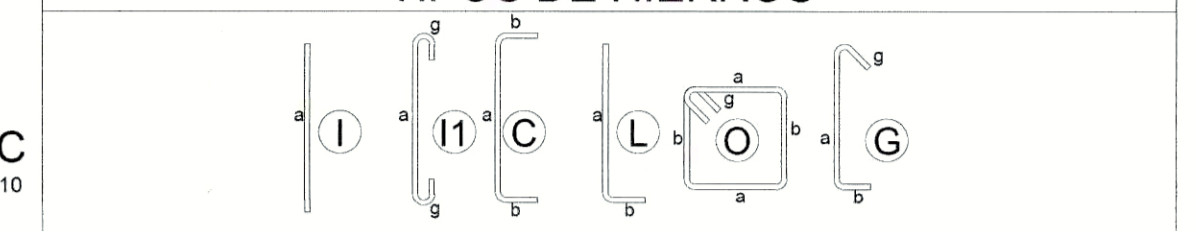

**RESUMEN DE MATERIALES**

NOTA: RESUMEN DE MATERIALES NO CONTEMPLA DESPERDICIOS POR FABRICACION Y MONTAJE

**CUADRO DE VIGAS ACERO A-36**

CUBIERTA					
VIGA	N	L VIGA (mm)	a(mm)	b(mm)	L TOTAL (m)
<b>VIGA PRINCIPAL (VPB)</b>					
VSB 10	3	8690	---	---	26.07
VSB 11	2	2943	---	---	5.89
VSB 12	2	6465	---	---	12.93
VSB 13	2	6195.88	---	---	12.40
VSB 14	2	5247	---	---	10.49
VSB 15	4	8011.48	---	---	32.05
VSB 16	1	4953	---	---	4.95
VSB 17	1	3644	---	---	3.64
	17				<b>TOTAL 108.42</b>
<b>VIGA SECUNDARIA (VSC)</b>					
VSC 10	4	3081	---	---	12.33
VSC 11	4	2622	---	---	10.49
	8				<b>TOTAL 22.82</b>
<b>VIGA SECUNDARIA (VSD)</b>					
VSD 1	13	3752	---	---	48.78
	13				<b>TOTAL 48.78</b>
<b>CORREA TIPO (CC)</b>					
CC 1	2	10000	---	---	20.00
CC 2	2	7943	---	---	15.89
CC 3	2	6008	---	---	12.02
CC 4	2	4073	---	---	8.15
CC 5	2	2138	---	---	4.28
CC 6	2	324	---	---	0.65
CC 7	2	11695	---	---	23.39
CC 8	2	9290	---	---	18.58
CC 9	2	7027	---	---	14.05
CC 10	2	4767	---	---	9.53
CC 11	2	2500	---	---	5.00
CC 12	2	380	---	---	0.76
	24				<b>TOTAL 132.29</b>

**PLETINAS PARA VIGAS DE CUBIERTA**

ACERO A-36 fy=2530 kg/cm2				
VIGA	ELEMENTO	PLETINA	LONG. (m)	PESO (Kg)
VSB	VIGA	2G 200x50x15x3	216.84	1585.11
VSC	TUBO	TB 150x100x2	22.82	171.12
VSD	TUBO	TB 150x50x2	48.78	289.73
CC	CORREA	G 150x50x15x2	132.29	832.10
				<b>TOTAL 2878.06</b>

**PLACAS DE UNION**

ACERO DE REFUERZO fy=2530 kg/cm2		
PLACA	UNIDADES(u)	PESO(Kg)
PL 200x150x6	2	2.83
PL 150x100x6	8	5.66
		<b>TOTAL= 8.49</b>

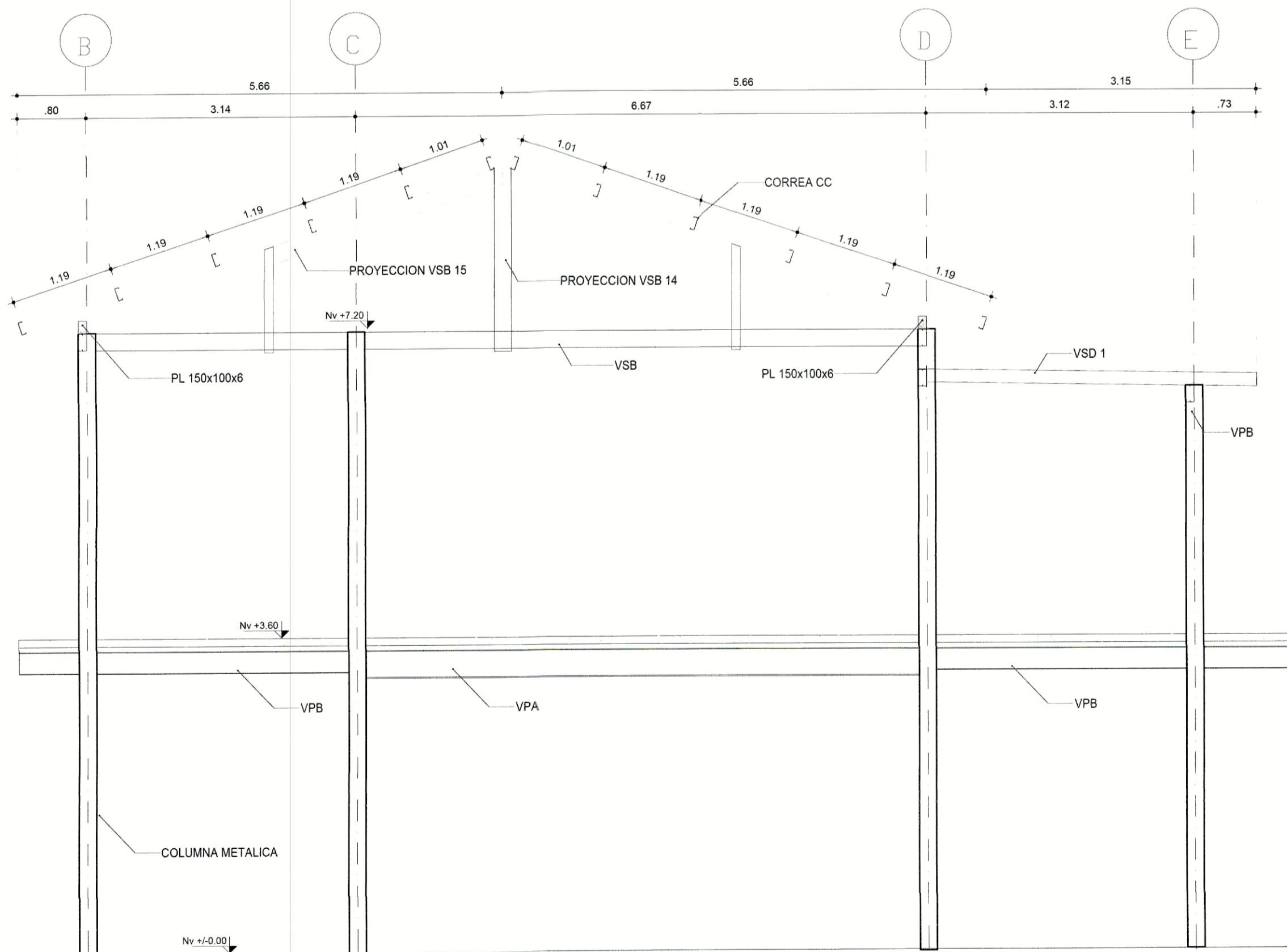

**PORTICO EJE 1,3**  
ESCALA 1:100

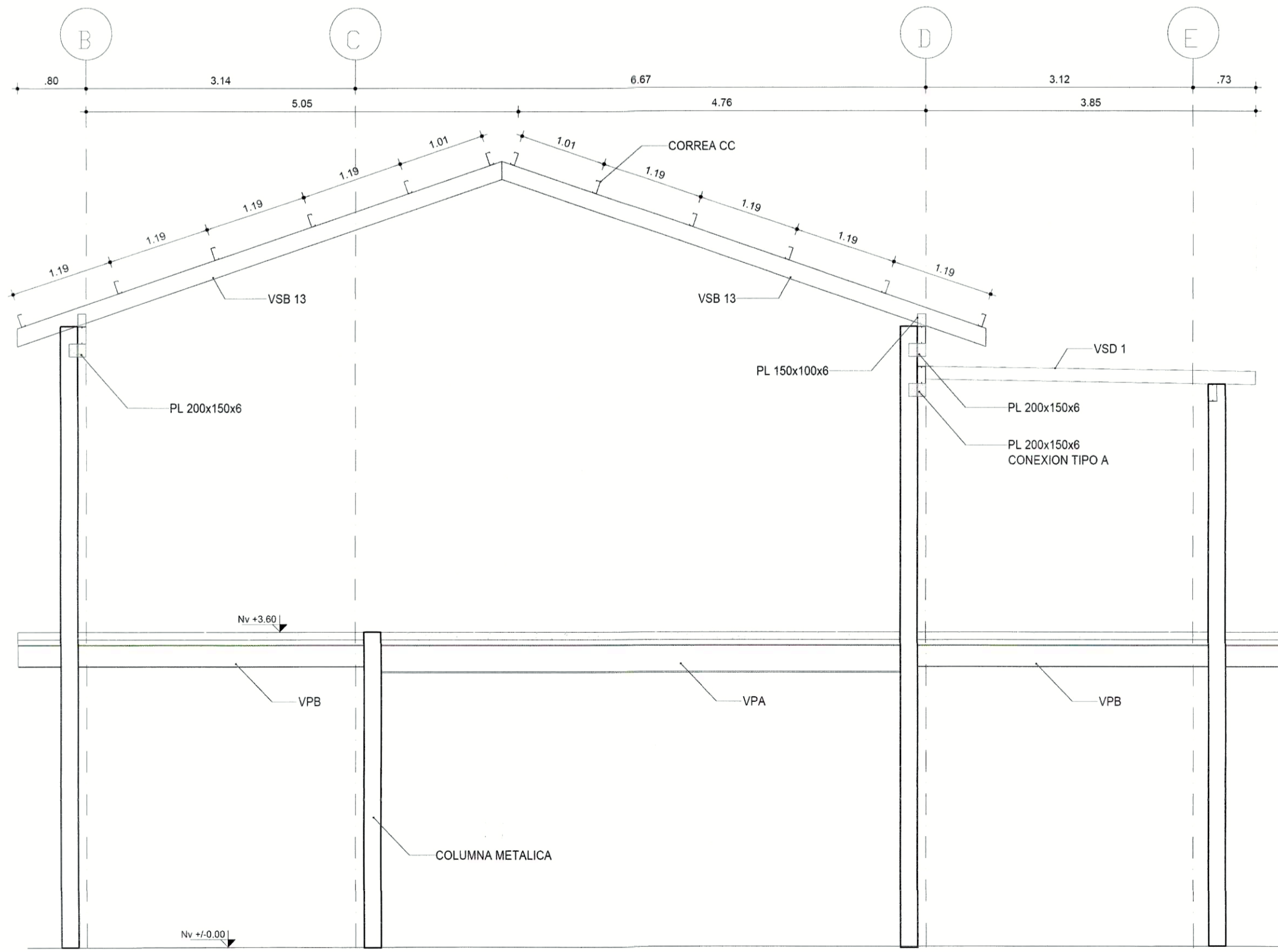

**PORTICO EJE 2**  
ESCALA 1:100

PROYECTO: **AMPLIACION PASEO DEL PARQUE**

CALCULO ESTRUCTURAL:

PROPIETARIO:

ING. FRANKLIN QUISILEMA G.  
C.C. 17192942-2  
R. PROF. 8995  
CENESCYT 1005-11-1053152

ESCALA: INDICADAS

FECHA: JUNIO 2022

DIBUJO: F.F.Q.G.

LAMINA: **E3**