

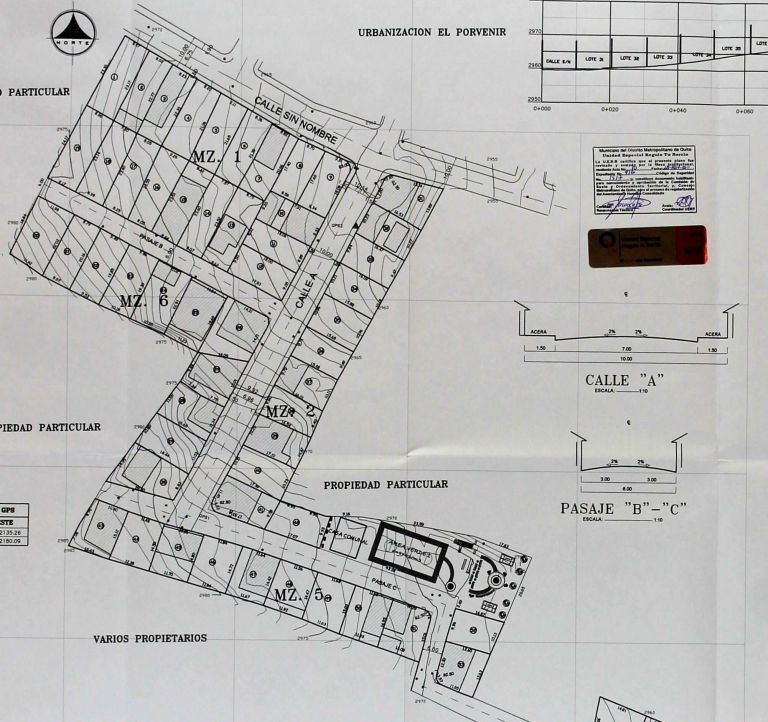

PROPIEDAD PARTICULAR

URBANIZACION EL PORVENIR



PROPIEDAD PARTICULAR

PROPIEDAD PARTICULAR

VARIOS PROPIETARIOS

### PLANO GENERAL DE IMPLANTACION

ESCALA: 1 : 500

| CUADRO DE PUNTOS GPS |                |                |
|----------------------|----------------|----------------|
| Nº                   | NORTE          | ESTE           |
| 1                    | 9 492.913 - 38 | 1 492.732 - 24 |
| 2                    | 9 498.212 - 42 | 1 492.103 - 03 |

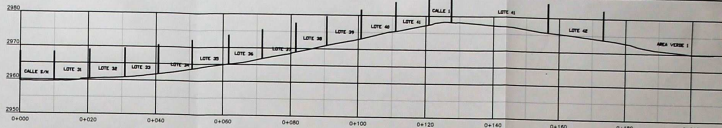

### PERFIL DEL TERRENO

ESCALA 1:500

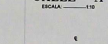

| CUADRO DE LOTES |           |   |             |
|-----------------|-----------|---|-------------|
| Nº              | AREA      | REPRESENTANTE LEGAL                         | Nº CESSALA  |
| 1               | 291.84    | OSCARO TAYAR EGOR PATRICK                   | 1378678.78  |
| 2               | 180.88    | HELENE DE CORDOBA ROSA FLOREDO              | 0615367.38  |
| 3               | 197.78    | FRANCISCA GARCIA BARRERA                    | 1711959.16  |
| 4               | 191.48    | PATRICIA FLOREDO CAMEN SUZALIFE             | 1702843.8   |
| 5               | 195.00    | HELENE DE CORDOBA ROSA FLOREDO              | 0615367.38  |
| 6               | 177.38    | RONIVIA DELGADO LAURA MARINA                | 1706242.25  |
| 7               | 188.49    | LEIDA CHOCOLA FLORES DELGADO                | 1707006.9   |
| 8               | 151.00    | CAROLINA MONTE MARA MARLENE                 | 1714970.94  |
| 9               | 188.39    | CAROLINA MONTE MARA MARLENE                 | 1714970.94  |
| 10              | 188.37    | JOHANNESSA ANALIA ESPINOSA LUCIANO          | 1718979.74  |
| 11              | 188.37    | JOHANNESSA ANALIA ESPINOSA LUCIANO          | 1718979.74  |
| 14              | 198.64    | AVICELLA MENDEZ ROSA ELBA                   | 1709509.04  |
| 15              | 209.27    | YUSICA IVAN ESPINOSA ELBA                   | 1709509.04  |
| 16              | 198.49    | SANTANA TALEGANDA XAVIER DELVIA             | 1708079.79  |
| 18              | 188.39    | TOYO WILSON BUSTOZA                         | 1709509.04  |
| 19              | 188.49    | CRISTINA DEL MARA COVARRUBIAS               | 1709509.04  |
| 19              | 182.49    | DAVID ABALGADO IVHENA ALEXANDRA             | 1714980.04  |
| 20              | 188.49    | ESTRELLA ISABEL MARA DELVIA AROCA           | 0620278.1   |
| 20              | 218.98    | ESTRELLA ISABEL MARA DELVIA AROCA           | 0620278.1   |
| 21              | 178.75    | LUARBO TALAORIO JOSE SALDON                 | 1810947.70  |
| 22              | 200.35    | LUYDIA PATRICIA ARA BARRERA                 | 1718980.04  |
| 23              | 188.39    | OSCARO ARA PATRICIA BARRERA                 | 1717942.18  |
| 24              | 208.84    | OSCARO ARA PATRICIA BARRERA                 | 1717942.18  |
| 25              | 214.85    | CARLOS LINHSA FREDY MARQUEL                 | 1802713.18  |
| 26              | 188.98    | YULIVIANCHO PEREZ OSCAR PATRICK             | 06003189.0  |
| 27              | 188.98    | ANDRÉS VALLEJO DOVATTA SALVO                | 0514518.00  |
| 28              | 214.92    | ESTRELLA ISABEL MARA DELVIA AROCA           | 1714970.94  |
| 29              | 180.73    | DA ZAPATA RITA SENDOVA                      | 1708811.85  |
| 30              | 195.93    | ALVARO GONZALEZ FRANCISCO                   | 1703019.18  |
| 31              | 188.14    | MICHOCHO MICHOCHO ANA LUCIA                 | 1718010.27  |
| 32              | 188.13    | MICHOCHO MICHOCHO ANA LUCIA                 | 1718010.27  |
| 33              | 187.18    | MARLENE IVHENA FRANCISCA DELGADO            | 0613217.18  |
| 34              | 188.48    | FRANCISCA DELVIA FLORES DELGADO             | 0615367.38  |
| 35              | 174.48    | MICHOCHO JOSÉ MABEL                         | 1709511.88  |
| 36              | 188.37    | FRANCISCA DELVIA FLORES DELGADO             | 0615367.38  |
| 37              | 154.45    | CERILA FANCHE FLOJA JACQUELINE              | 1138104.79  |
| 38              | 188.49    | MARLENE IVHENA FRANCISCA DELGADO            | 1718980.04  |
| 38              | 178.39    | MARLENE IVHENA FRANCISCA DELGADO            | 1718980.04  |
| 39              | 277.38    | FRAZTA FLORES IVHENA FRANCISCA DELGADO      | 1718980.04  |
| 41              | 188.64    | LUCIA QUILLAGAMA LUCIDES VELAZO             | 17117215.2  |
| 42              | 353.05    | MONTANA LILIANA RAMIRO GARCIA               | 1702842.25  |
| 43              | 171.05    | BERTHA OLIVERA RAMIRO GARCIA                | 1702842.25  |
| 44              | 178.18    | ONIVIA CHACUA EDGAR ALFARO                  | 1707888.11  |
| 45              | 174.11    | DANIELA ANAYA GARCIA PATRICIA MARLENE       | 131088186.0 |
| 46              | 174.18    | RODRIGUEZ FERRAZ PABLO FRANCISCO            | 131088186.0 |
| 47              | 174.18    | BURGUESA CHACUA FELIX VINCENZO              | 1718484.9   |
| 48              | 188.54    | IVHENA FRANCISCA DELVIA AROCA               | 1713288.74  |
| 49              | 174.27    | LUCIA QUILLAGAMA LUCIDES VELAZO             | 1718484.9   |
| 50              | 178.14    | BURGUESA CHACUA EDWIN GUZMÁN                | 1718218.2   |
| 51              | 188.19    | PERLA MARÍA DE FRANCISCA TAYAR EGOR PATRICK | 06001479.04 |
| 52              | 141.12    | YULIVIANCHO PEREZ OSCAR PATRICK             | 06001482.3  |
| 53              | 188.18    | ANDRÉS VALLEJO ALEXANDRA BURBANA            | 0315773.9   |
| 54              | 200.15    | OSCARO ARA PATRICIA BARRERA                 | 1718980.04  |
| 55              | 180.07    | ORTIZ VELA MARA MARLENE                     | 1700006.2   |
| 56              | 206.78    | FRANCISCA DELVIA FLORES DELGADO             | 1700006.2   |
| 57              | 188.66    | MICHOCHO JOSÉ SENDOVA BARBARA               | 0601479.04  |
| 58              | 214.92    | FRANCISCA DELVIA FLORES DELGADO             | 0601479.04  |
| TOTAL           | 10 564.18 |   |             |

| RESUMEN DE AREAS                                      |           |        |
|---|-----------|--------|
| DESCRIPCION   | AREA (m2) | %      |
| AREA DE LOTES   | 10 564.18 | 72.33  |
| AREA DE VIAS  | 3 031.79  | 20.76  |
| AREA VERDE (9.55% DEL AREA UTIL DE LOTES 10 564.18m2) | 1 008.97  | 6.91   |
| TOTAL   | 14 604.94 | 100.00 |

| DESCRIPCION        |           |      |
|--------------------|-----------|------|
| DESCRIPCION        | AREA (m2) | %    |
| AREA UTIL DE LOTES | 10 564.18 | 100  |
| AREA VERDE         | 1 008.97  | 9.55 |

| AREAS VERDES |           |
|--------------|-----------|
| Nº           | AREA (m2) |
| AREA VERDE 1 | 974.60    |
| AREA VERDE 2 | 34.37     |
| TOTAL        | 1 008.97  |

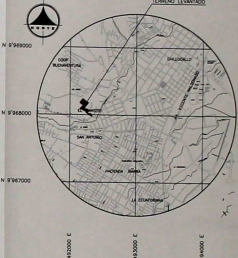

UBICACION  
ESCALA 1:25000

| EXPOSICION DEL PLAN DE LOTEOS DE LOS LOTES |           |             |
|--|-----------|-------------|
| PROPIETARIO                                | AREA (m2) | VALOR (COP) |
| 1  | 291.84    | 10 000 000  |
| 2  | 180.88    | 10 000 000  |
| 3  | 197.78    | 10 000 000  |
| 4  | 191.48    | 10 000 000  |
| 5  | 195.00    | 10 000 000  |
| 6  | 177.38    | 10 000 000  |
| 7  | 188.49    | 10 000 000  |
| 8  | 151.00    | 10 000 000  |
| 9  | 188.39    | 10 000 000  |
| 10   | 188.37    | 10 000 000  |
| 11   | 188.37    | 10 000 000  |
| 14   | 198.64    | 10 000 000  |
| 15   | 209.27    | 10 000 000  |
| 16   | 198.49    | 10 000 000  |
| 18   | 188.39    | 10 000 000  |
| 19   | 188.49    | 10 000 000  |
| 19   | 182.49    | 10 000 000  |
| 20   | 188.49    | 10 000 000  |
| 20   | 218.98    | 10 000 000  |
| 21   | 178.75    | 10 000 000  |
| 22   | 200.35    | 10 000 000  |
| 23   | 188.39    | 10 000 000  |
| 24   | 208.84    | 10 000 000  |
| 25   | 214.85    | 10 000 000  |
| 26   | 188.98    | 10 000 000  |
| 27   | 188.98    | 10 000 000  |
| 28   | 214.92    | 10 000 000  |
| 29   | 180.73    | 10 000 000  |
| 30   | 195.93    | 10 000 000  |
| 31   | 188.14    | 10 000 000  |
| 32   | 188.13    | 10 000 000  |
| 33   | 187.18    | 10 000 000  |
| 34   | 188.48    | 10 000 000  |
| 35   | 174.48    | 10 000 000  |
| 36   | 188.37    | 10 000 000  |
| 37   | 154.45    | 10 000 000  |
| 38   | 188.49    | 10 000 000  |
| 38   | 178.39    | 10 000 000  |
| 39   | 277.38    | 10 000 000  |
| 41   | 188.64    | 10 000 000  |
| 42   | 353.05    | 10 000 000  |
| 43   | 171.05    | 10 000 000  |
| 44   | 178.18    | 10 000 000  |
| 45   | 174.11    | 10 000 000  |
| 46   | 174.18    | 10 000 000  |
| 47   | 174.18    | 10 000 000  |
| 48   | 188.54    | 10 000 000  |
| 49   | 174.27    | 10 000 000  |
| 50   | 178.14    | 10 000 000  |
| 51   | 188.19    | 10 000 000  |
| 52   | 141.12    | 10 000 000  |
| 53   | 188.18    | 10 000 000  |
| 54   | 200.15    | 10 000 000  |
| 55   | 180.07    | 10 000 000  |
| 56   | 206.78    | 10 000 000  |
| 57   | 188.66    | 10 000 000  |
| 58   | 214.92    | 10 000 000  |
| TOTAL                                      | 10 564.18 | 10 000 000  |

BARRIO "NUEVO AMANECER Nº 2"  
SECTOR EL TRAMITO-COLLAGALA PROVINCIA DE PASTAZA

CL. CAT.: 31913-02-011  
PREDDI.: 187778

PROYECTO DE LOTES  
CUADRO DE AREAS  
PROYECTADO POR: [Firma]  
ESCALA: 1:500  
NOV. - 2011

MUNICIPIO DEL DISTRITO DE COLLAGALA DE COTACACHI  
La Secretaría de Turismo, Cultura y Patrimonio, en cumplimiento de sus funciones, ha expedido el presente Decreto, en virtud del cual se declara de Interés Municipal el Proyecto de Loteos del Barrio "Nuevo Amanecer Nº 2" en el Sector El Tránsito-Collagala, Provincia de Pastaza.

En virtud de lo anterior, el Consejo Municipal de Pastaza, en sesión ordinaria celebrada el día 14 de mayo de 2011, en la ciudad de Pastaza, a las 10:00 horas, aprobó el presente Decreto.

La corrección: [Firma]  
Secretaría de Turismo, Cultura y Patrimonio

La corrección: [Firma]  
Secretaría General del Gobierno Municipal de Cotacachi